

12.529.

Cuevas del Siete — Expropiación de terrenos

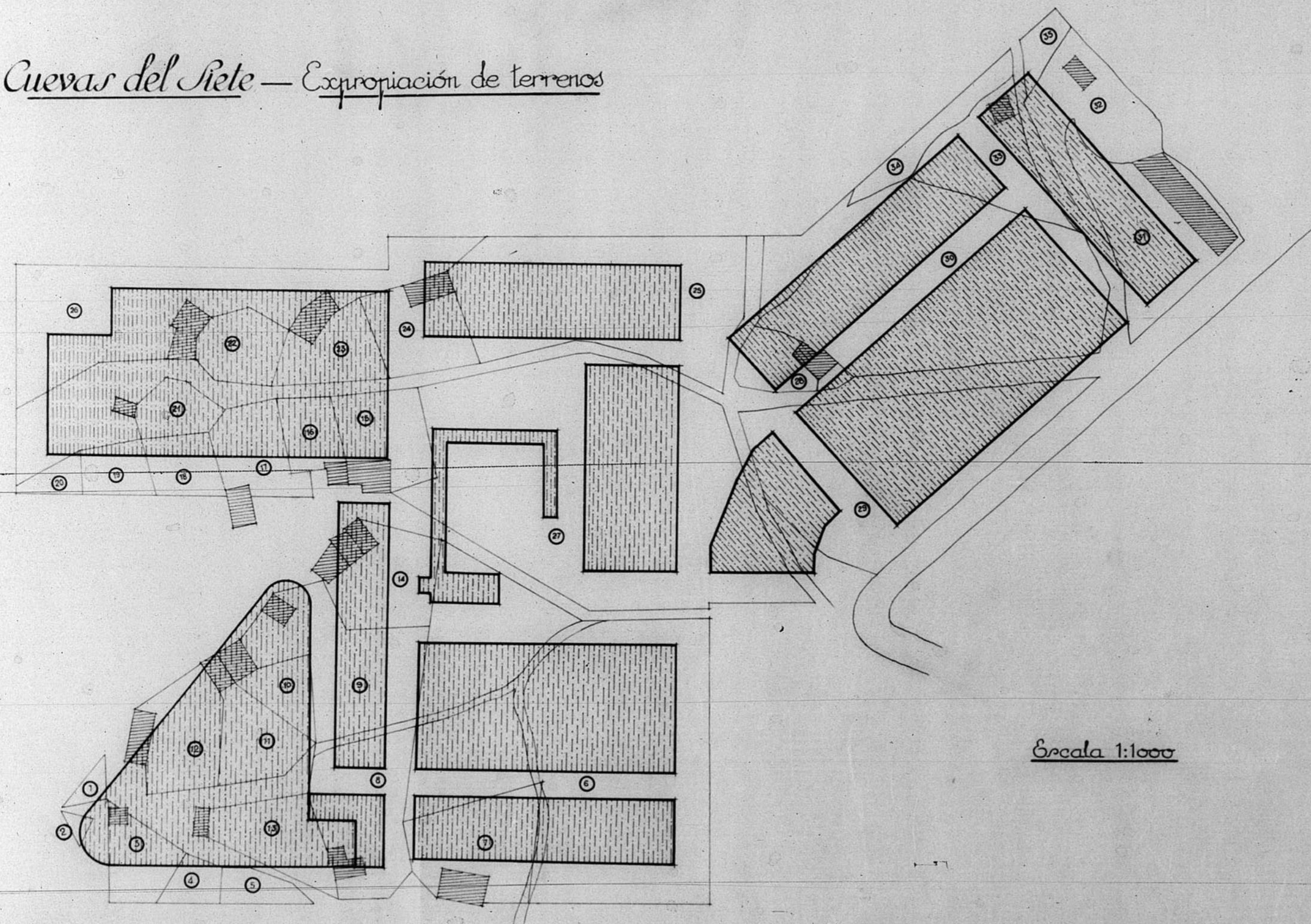

Escala 1:1000

Nº DEL PLANO	EMPLAZAMIENTO CALLE	PROPIETARIO		SUPERFICIE M ²		VALORACIONES		VALOR ESPICACION	VALOR TOTAL
		NOMBRE	DOMICILIO	EDIFICIO	ENGRABADO	VALOR M ²	VALOR SOLAR		
1	CUEVAS DEL SIETE.	MARIA CALVO		121.50	121.50	2.00	243.00		243.00
2	"	MANUEL GALVE		65.70	65.70	2.00	131.40		131.40
3	"	MANUEL ALVAREZ - TERESA QUILLEN - TERESA PARDIÑAS Y JOSÉ IBÁÑEZ		595.57	631.32	2.00	1262.64		1262.64
4	"	V ^{SA} DE LANCHIA		270.10	270.10	2.00	540.20		540.20
5	"	JOSÉ VILLARROYA		275.95	275.95	2.00	551.90		551.90
6	"	V ^{SA} DE JOSÉ BARRACHINA		856.22	806.22	3.00	2994.77		2994.77
7	"	H ^{OS} DE EUGENIO MUÑOZ		119.55	1227.04	3.00	4279.77	12.927.60	17147.37
8	"	CRISTÓBAL DE GRACIA		91.43	1584.96	2.25	3785.37	3.685.00	7470.37
9	"	JUAN LAFUENTE NAVARRO		02.28	1026.71	2.25	4234.72	3.144.00	7378.72
10	"	SANTIAGO MAICAS		119.00	453.21	2.00	1163.42		1163.42
11	"	SANTIAGO MAICAS		66.64	614.83	2.00	1231.66		1231.66
12	"	DAMAZO MARTÍN NAVARRO		135.75	921.14	2.00	2133.38		2133.38
13	"	MANUEL GALVE		1177.2	740.33	6.00	2971.30	3780.00	6751.30
14	"	FEDERICO VILLARROYA		2070.2	981.60	2.50	2481.45	5.156.40	7637.85
15	"	MANUEL GARZARAN		126.41	852.17	2.50	2481.45		2481.45
16	"	RAMON POLO		02.37	450.32	2.00	1025.38	2494.00	3519.38
17	"	H ^{OS} DE JOSÉ EL HACHERO		32.30	730.07	2.00	1644.14	500.00	2144.14
18	"	FRANCISCO RUEDA		445.88	445.88	2.00	891.76		891.76
19	"	DOMINGO GARZARAN LUCIA		393.96	393.96	2.00	787.92		787.92
20	"	FRANCISCA GARZAN (LA CARACOLA)		211.91	211.91	2.00	423.82		423.82
21	"	LAUREANO TODAN		33.97	411.96	2.00	823.92	2038.20	2862.12
22	"	CAMILO VILLARROYA		173.68	623.16	2.00	1246.32	8648.00	9894.32
23	"	JOSÉ CHICHEL		143.28	661.99	2.00	1323.98		1323.98
24	"	JOSÉ FÁNCHEZ		114.75	812.12	2.75	2548.87	2254.00	4802.87
25	"	JOSÉ VILLARROYA		3428.00	3428.00	3.50	11998.00		11998.00
26	"	RAMON VILLARROYA		3265.29	3265.29	2.00	6530.58		6530.58
27	"	EXCMO. AYUNTAMIENTO ROMÁN DE GRACIA		0070.00	8078.00				
28	"			170.00	428.74	4.00	2087.16	22334.10	24421.26
29	"	H ^{OS} DE DANIEL LAMO		4336.85	4336.85	5.00	21684.25		21684.25
30	"	FLORENTIN MATEO		5403.81	5403.81	4.50	24317.14		24317.14
31	"	RAUL LARIO		337.70	1683.33	3.00	10406.25		10406.25
32	"	PEDRO MAICAS		60.00	1151.20	4.00	5456.80	5721.60	10178.40
33	"	FRANCISCO ORTIZ		56.00	1182.38	4.00	4853.52		4853.52
34	"	VICENTE MARIN		600.00	600.00	4.00	2400.00		2400.00
35	"	RAMON VILLARROYA		224.50	224.50	4.00	898.00		898.00
				TOTAL			199178.46	90984.84	290163.30

Febrero y Diciembre de 1943

El Arquitecto,

José Maiztegui

