

INSTITUTO DE LA CONSTRUCCION
CARRANZA 100
MEXICO D.F.
TEL. 52 52 52 52

PROYECTO DE EXPANSIÓN Y NUEVA CONEXIÓN EN EL BARRIO DE LA CATEDRAL DE LA CIUDAD DE HUECA

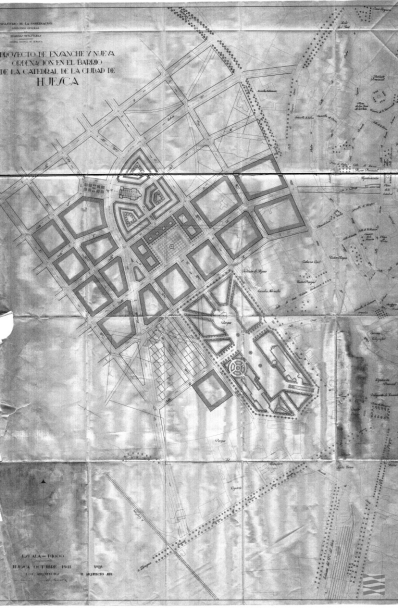

EST. MA. PRON
HUECA OCTUBRE 1941
CALLE DE LA CATEDRAL
MEXICO D.F.

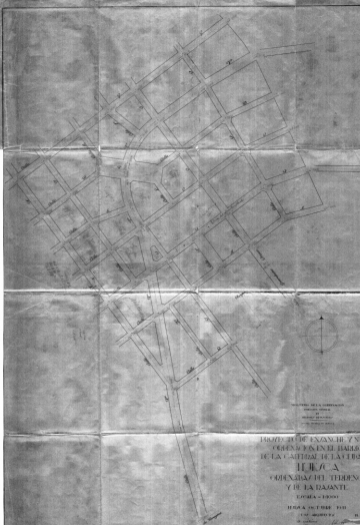

MINISTERIO DE LA INSTRUCCION
 Y DE LA CULTURA
 DEPARTAMENTO DE INGENIERIA Y ARQUITECTURA

PROYECTO DE ENLACE Y NUEVA
 ORDENACION EN EL BARRIO
 DE LA CATEDRAL DE LA CIUDAD DE
LIMA
 ORDENADA DEL TERRENO
 Y DE LA BASANTE

LIMA - 1900

HOJA N.º 1 DE 10

C.º DE INGENIEROS Y ARQUITECTOS
 DE LIMA



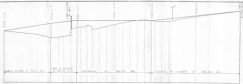

1911
 1912
 1913
 1914
 1915
 1916
 1917
 1918
 1919
 1920
 1921
 1922
 1923
 1924
 1925
 1926
 1927
 1928
 1929
 1930
 1931
 1932
 1933
 1934
 1935
 1936
 1937
 1938
 1939
 1940
 1941
 1942
 1943
 1944
 1945
 1946
 1947
 1948
 1949
 1950
 1951
 1952
 1953
 1954
 1955
 1956
 1957
 1958
 1959
 1960
 1961
 1962
 1963
 1964
 1965
 1966
 1967
 1968
 1969
 1970
 1971
 1972
 1973
 1974
 1975
 1976
 1977
 1978
 1979
 1980
 1981
 1982
 1983
 1984
 1985
 1986
 1987
 1988
 1989
 1990
 1991
 1992
 1993
 1994
 1995
 1996
 1997
 1998
 1999
 2000
 2001
 2002
 2003
 2004
 2005
 2006
 2007
 2008
 2009
 2010
 2011
 2012
 2013
 2014
 2015
 2016
 2017
 2018
 2019
 2020
 2021
 2022
 2023
 2024
 2025
 2026
 2027
 2028
 2029
 2030
 2031
 2032
 2033
 2034
 2035
 2036
 2037
 2038
 2039
 2040
 2041
 2042
 2043
 2044
 2045
 2046
 2047
 2048
 2049
 2050
 2051
 2052
 2053
 2054
 2055
 2056
 2057
 2058
 2059
 2060
 2061
 2062
 2063
 2064
 2065
 2066
 2067
 2068
 2069
 2070
 2071
 2072
 2073
 2074
 2075
 2076
 2077
 2078
 2079
 2080
 2081
 2082
 2083
 2084
 2085
 2086
 2087
 2088
 2089
 2090
 2091
 2092
 2093
 2094
 2095
 2096
 2097
 2098
 2099
 2100

Records of the
 Dept. of
 State
 Office of
 the Secretary of State
 Department of State
 Washington, D.C.



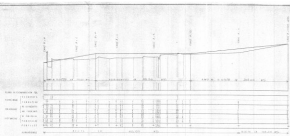

*Compte rendu de l'Assemblée
 Générale de la Société
 1900*



Memorandum of Proceedings

of the

Board of Directors

of the



For the Board of Directors
[Signature]



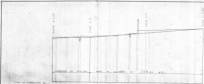

- 1.00
- 1.25
- 1.50

Warrant of Capture
By the Court
 No. 10

John Doe
John Doe

1865

John Doe
John Doe

John Doe

NY

TITULO DE COMERCIO DE
 COTIZACION
 DIVISION
 MONEDA
 VALOR
 MONEDA



TIEMPO DE ... VALOR DE ...

TITULO DE COMERCIO DE
 COTIZACION
 DIVISION
 MONEDA
 VALOR
 MONEDA



TIEMPO DE ... VALOR DE ...

Banco de España
 del Real
 de 1878

Banco central de
 España



Banco de España
 del Real
 de 1878

1. 1000
 2. 1000
 3. 1000
 4. 1000
 5. 1000
 6. 1000
 7. 1000
 8. 1000
 9. 1000
 10. 1000
 11. 1000
 12. 1000
 13. 1000
 14. 1000
 15. 1000
 16. 1000
 17. 1000
 18. 1000
 19. 1000
 20. 1000
 21. 1000
 22. 1000
 23. 1000
 24. 1000
 25. 1000
 26. 1000
 27. 1000
 28. 1000
 29. 1000
 30. 1000
 31. 1000
 32. 1000
 33. 1000
 34. 1000
 35. 1000
 36. 1000
 37. 1000
 38. 1000
 39. 1000
 40. 1000
 41. 1000
 42. 1000
 43. 1000
 44. 1000
 45. 1000
 46. 1000
 47. 1000
 48. 1000
 49. 1000
 50. 1000
 51. 1000
 52. 1000
 53. 1000
 54. 1000
 55. 1000
 56. 1000
 57. 1000
 58. 1000
 59. 1000
 60. 1000
 61. 1000
 62. 1000
 63. 1000
 64. 1000
 65. 1000
 66. 1000
 67. 1000
 68. 1000
 69. 1000
 70. 1000
 71. 1000
 72. 1000
 73. 1000
 74. 1000
 75. 1000
 76. 1000
 77. 1000
 78. 1000
 79. 1000
 80. 1000
 81. 1000
 82. 1000
 83. 1000
 84. 1000
 85. 1000
 86. 1000
 87. 1000
 88. 1000
 89. 1000
 90. 1000
 91. 1000
 92. 1000
 93. 1000
 94. 1000
 95. 1000
 96. 1000
 97. 1000
 98. 1000
 99. 1000
 100. 1000

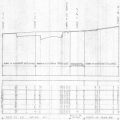

Certificate of Approval
 Dept. of Agriculture
 Building 100

State of California
 Department of Agriculture

100



Approved by the Department of Agriculture
 on this 10th day of January, 1910
 State of California

100

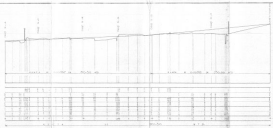

1. LARGHEZZA IN
 2. LARGHEZZA IN
 3. LARGHEZZA IN
 4. LARGHEZZA IN
 5. LARGHEZZA IN
 6. LARGHEZZA IN
 7. LARGHEZZA IN
 8. LARGHEZZA IN
 9. LARGHEZZA IN
 10. LARGHEZZA IN
 11. LARGHEZZA IN
 12. LARGHEZZA IN
 13. LARGHEZZA IN
 14. LARGHEZZA IN
 15. LARGHEZZA IN
 16. LARGHEZZA IN
 17. LARGHEZZA IN
 18. LARGHEZZA IN
 19. LARGHEZZA IN
 20. LARGHEZZA IN
 21. LARGHEZZA IN
 22. LARGHEZZA IN
 23. LARGHEZZA IN
 24. LARGHEZZA IN
 25. LARGHEZZA IN
 26. LARGHEZZA IN
 27. LARGHEZZA IN
 28. LARGHEZZA IN
 29. LARGHEZZA IN
 30. LARGHEZZA IN
 31. LARGHEZZA IN
 32. LARGHEZZA IN
 33. LARGHEZZA IN
 34. LARGHEZZA IN
 35. LARGHEZZA IN
 36. LARGHEZZA IN
 37. LARGHEZZA IN
 38. LARGHEZZA IN
 39. LARGHEZZA IN
 40. LARGHEZZA IN
 41. LARGHEZZA IN
 42. LARGHEZZA IN
 43. LARGHEZZA IN
 44. LARGHEZZA IN
 45. LARGHEZZA IN
 46. LARGHEZZA IN
 47. LARGHEZZA IN
 48. LARGHEZZA IN
 49. LARGHEZZA IN
 50. LARGHEZZA IN
 51. LARGHEZZA IN
 52. LARGHEZZA IN
 53. LARGHEZZA IN
 54. LARGHEZZA IN
 55. LARGHEZZA IN
 56. LARGHEZZA IN
 57. LARGHEZZA IN
 58. LARGHEZZA IN
 59. LARGHEZZA IN
 60. LARGHEZZA IN
 61. LARGHEZZA IN
 62. LARGHEZZA IN
 63. LARGHEZZA IN
 64. LARGHEZZA IN
 65. LARGHEZZA IN
 66. LARGHEZZA IN
 67. LARGHEZZA IN
 68. LARGHEZZA IN
 69. LARGHEZZA IN
 70. LARGHEZZA IN
 71. LARGHEZZA IN
 72. LARGHEZZA IN
 73. LARGHEZZA IN
 74. LARGHEZZA IN
 75. LARGHEZZA IN
 76. LARGHEZZA IN
 77. LARGHEZZA IN
 78. LARGHEZZA IN
 79. LARGHEZZA IN
 80. LARGHEZZA IN
 81. LARGHEZZA IN
 82. LARGHEZZA IN
 83. LARGHEZZA IN
 84. LARGHEZZA IN
 85. LARGHEZZA IN
 86. LARGHEZZA IN
 87. LARGHEZZA IN
 88. LARGHEZZA IN
 89. LARGHEZZA IN
 90. LARGHEZZA IN
 91. LARGHEZZA IN
 92. LARGHEZZA IN
 93. LARGHEZZA IN
 94. LARGHEZZA IN
 95. LARGHEZZA IN
 96. LARGHEZZA IN
 97. LARGHEZZA IN
 98. LARGHEZZA IN
 99. LARGHEZZA IN
 100. LARGHEZZA IN

Istituto di Studi
 dell'Ingegneria
 del 5

Corso di Studi
 in Ingegneria

68



Prof. *[Signature]*
 Ingegnere



Compte de l'Année

1887

1888

Compte rendu

de l'Assemblée

générale



Paris, le 15 Mars 1888

Le Président de l'Assemblée générale,
M. [Signature]



PROF. DR. ...

...
...
...
...
...

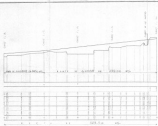

Remerciement

M. ...

...

...

...



...

...

...

...

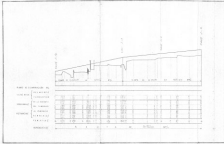

Rechnung der Kosten
des Schiffes
 Nr. 17
 Aufgetragen von
 dem Reichsmarineamt
 1881

 Reichsmarineamt
 Berlin

1881

NAME OF COMMANDER IN CHIEF
 NAME OF VESSEL
 SERVICE
 POSITION
 GRADE
 DATE



TIME	1	2	3	4	5	6	7	8	9	10	11	12	13	14	15	16	17	18	19	20	
1000																					
2000																					
3000																					
4000																					

Received at Office
 Dept. of State
 Feb. 18

Received at
 Dept. of State



MY

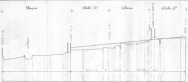

Scale of vertical axis
 1 cm = 100 units
 1 cm = 100 units
 1 cm = 100 units
 1 cm = 100 units
 1 cm = 100 units
 1 cm = 100 units
 1 cm = 100 units

Time	Amplitude	Phase	Frequency
0	0	0	0
1	10	0	0
2	5	90	0
3	10	0	0
4	15	0	0
5	20	0	0
6	25	0	0
7	30	0	0
8	35	0	0
9	40	0	0
10	45	0	0
11	50	0	0
12	55	0	0
13	60	0	0
14	65	0	0
15	70	0	0
16	75	0	0
17	80	0	0
18	85	0	0
19	90	0	0
20	95	0	0
21	100	0	0
22	100	0	0
23	100	0	0
24	100	0	0
25	100	0	0
26	100	0	0
27	100	0	0
28	100	0	0
29	100	0	0
30	100	0	0
31	100	0	0
32	100	0	0
33	100	0	0
34	100	0	0
35	100	0	0
36	100	0	0
37	100	0	0
38	100	0	0
39	100	0	0
40	100	0	0

Records of Flow
Dept. Hospital
Flow rate 10 gal

Each vertical line
means 100 units

100



100

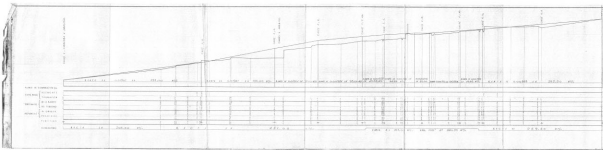

Compte de l'Etat
des Travaux
de l'Etat

Année 1880

Travaux de l'Etat

Travaux de l'Etat



Le Ministre des Travaux Publics



Paris, le 10 Mars 1881

Le Directeur des Travaux Publics



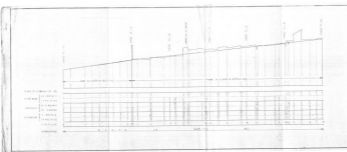

Compte de l'Etat
des Travaux
de 1870

(Seal)

1870

(Seal)

1870



Table 17

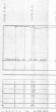

TABLE 17
 17-1
 17-2
 17-3
 17-4
 17-5
 17-6
 17-7
 17-8
 17-9
 17-10
 17-11
 17-12
 17-13
 17-14
 17-15
 17-16
 17-17
 17-18
 17-19
 17-20
 17-21
 17-22
 17-23
 17-24
 17-25
 17-26
 17-27
 17-28
 17-29
 17-30
 17-31
 17-32
 17-33
 17-34
 17-35
 17-36
 17-37
 17-38
 17-39
 17-40
 17-41
 17-42
 17-43
 17-44
 17-45
 17-46
 17-47
 17-48
 17-49
 17-50
 17-51
 17-52
 17-53
 17-54
 17-55
 17-56
 17-57
 17-58
 17-59
 17-60
 17-61
 17-62
 17-63
 17-64
 17-65
 17-66
 17-67
 17-68
 17-69
 17-70
 17-71
 17-72
 17-73
 17-74
 17-75
 17-76
 17-77
 17-78
 17-79
 17-80
 17-81
 17-82
 17-83
 17-84
 17-85
 17-86
 17-87
 17-88
 17-89
 17-90
 17-91
 17-92
 17-93
 17-94
 17-95
 17-96
 17-97
 17-98
 17-99
 17-100

Table 18



TABLE 18
 18-1
 18-2
 18-3
 18-4
 18-5
 18-6
 18-7
 18-8
 18-9
 18-10
 18-11
 18-12
 18-13
 18-14
 18-15
 18-16
 18-17
 18-18
 18-19
 18-20
 18-21
 18-22
 18-23
 18-24
 18-25
 18-26
 18-27
 18-28
 18-29
 18-30
 18-31
 18-32
 18-33
 18-34
 18-35
 18-36
 18-37
 18-38
 18-39
 18-40
 18-41
 18-42
 18-43
 18-44
 18-45
 18-46
 18-47
 18-48
 18-49
 18-50
 18-51
 18-52
 18-53
 18-54
 18-55
 18-56
 18-57
 18-58
 18-59
 18-60
 18-61
 18-62
 18-63
 18-64
 18-65
 18-66
 18-67
 18-68
 18-69
 18-70
 18-71
 18-72
 18-73
 18-74
 18-75
 18-76
 18-77
 18-78
 18-79
 18-80
 18-81
 18-82
 18-83
 18-84
 18-85
 18-86
 18-87
 18-88
 18-89
 18-90
 18-91
 18-92
 18-93
 18-94
 18-95
 18-96
 18-97
 18-98
 18-99
 18-100

Comando de Flores
 17-1
 17-2

17-3
 17-4

17-5



17-6
 17-7
 17-8
 17-9
 17-10
 17-11
 17-12
 17-13
 17-14
 17-15
 17-16
 17-17
 17-18
 17-19
 17-20
 17-21
 17-22
 17-23
 17-24
 17-25
 17-26
 17-27
 17-28
 17-29
 17-30
 17-31
 17-32
 17-33
 17-34
 17-35
 17-36
 17-37
 17-38
 17-39
 17-40
 17-41
 17-42
 17-43
 17-44
 17-45
 17-46
 17-47
 17-48
 17-49
 17-50
 17-51
 17-52
 17-53
 17-54
 17-55
 17-56
 17-57
 17-58
 17-59
 17-60
 17-61
 17-62
 17-63
 17-64
 17-65
 17-66
 17-67
 17-68
 17-69
 17-70
 17-71
 17-72
 17-73
 17-74
 17-75
 17-76
 17-77
 17-78
 17-79
 17-80
 17-81
 17-82
 17-83
 17-84
 17-85
 17-86
 17-87
 17-88
 17-89
 17-90
 17-91
 17-92
 17-93
 17-94
 17-95
 17-96
 17-97
 17-98
 17-99
 17-100



Estado de Gastos
 del **Departamento**
 de **Castellón**

Para el ejercicio de 1870

El **Jefe de la Oficina**
 de **Castellón**

Don **José María de la Cruz**

El Jefe de la Oficina
 de **Castellón**

Don José María de la Cruz

ANEXO
ESTADO DE GASTOS
DEL DEPARTAMENTO
DE CASTELLÓN
PARA EL EJERCICIO DE 1870

CATEGORÍA	DESCRIPCIÓN	CANTIDAD
1.		
2.		
3.		
4.		
5.		
6.		
7.		
8.		
9.		
10.		
11.		
12.		
13.		
14.		
15.		
16.		
17.		
18.		
19.		
20.		
21.		
22.		
23.		
24.		
25.		
26.		
27.		
28.		
29.		
30.		
31.		
32.		
33.		
34.		
35.		
36.		
37.		
38.		
39.		
40.		
41.		
42.		
43.		
44.		
45.		
46.		
47.		
48.		
49.		
50.		
51.		
52.		
53.		
54.		
55.		
56.		
57.		
58.		
59.		
60.		
61.		
62.		
63.		
64.		
65.		
66.		
67.		
68.		
69.		
70.		
71.		
72.		
73.		
74.		
75.		
76.		
77.		
78.		
79.		
80.		
81.		
82.		
83.		
84.		
85.		
86.		
87.		
88.		
89.		
90.		
91.		
92.		
93.		
94.		
95.		
96.		
97.		
98.		
99.		
100.		

ESTADO DE GASTOS
DEL DEPARTAMENTO
DE CASTELLÓN
PARA EL EJERCICIO DE 1870

M

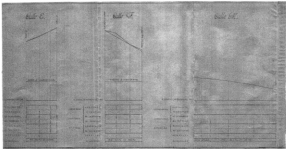

MT